

DSP-42-XX 01 Z (THT Type)

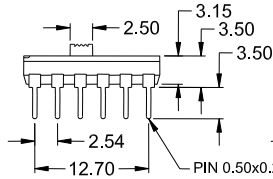

Low Profile Actuator

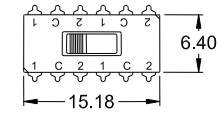
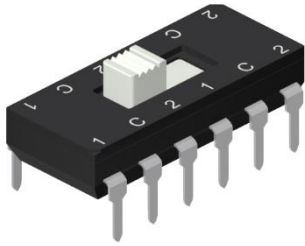
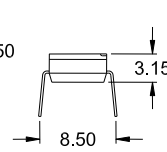

Extended Actuator

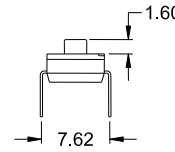

Circuit diagram

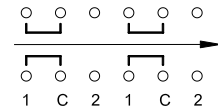

DSP-42-XX 02 Z (SMT Type)

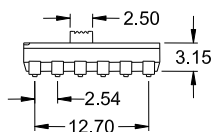
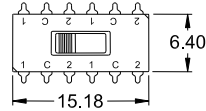
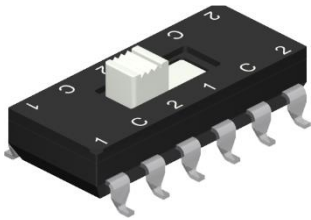

Low Profile Actuator

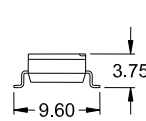

Extended Actuator

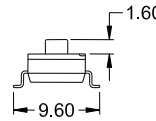

Circuit diagram

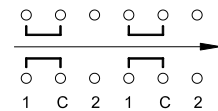

PCB Layout

DSP-42-XX 01 Z (THT Type)

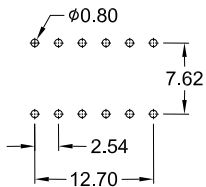

DSP-42-XX 02 Z (SMT Type)

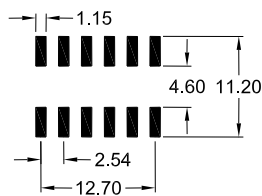

Option

Tape sealed

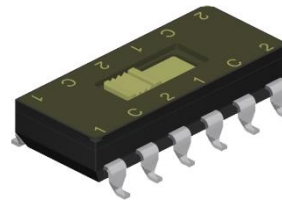

Application

Ideal as Function and Band Selector Switch in Radio-Cassette, Recorder, Office Equipment, TV sets, VCR etc.

SPECIFICATIONS

Electrical data

Contact Rating	25 mA, 24 V DC
-switching	100 mA, 50 V DC
-non-Switching	
Contact Resistance	
-initial	50 mΩ max.
-after life test	100 mΩ max.
Insulation Resistance	1000 MΩ min. at 100 V DC
Withstanding Voltage	500 V AC for 1 Minute
Capacitance between adjacent switches	5 pF max.

Mechanical and Environmental data

Operating Temperature	-25°C to +70°C
Storage Temperature	-40°C to +85°C
Soldering Temperature	
-SMT reflow soldering	250°C +0/-5°C for 10 sec. max.
-THT wave soldering	250°C +0/-5°C for 10 sec. max.
Operating Force	100 gf min / 1000 gf max.
Mechanical Life	1000 operations
Vibration	10 Hz – 50 Hz – 10 Hz for 6 hours

FEATURES

- Same size as an IC, 7.62mm (.300"), can be assembled by any automatic IC inserter
- Top tape sealed to withstand solder vapors and board washing
- All plastics used are UL 94V-0 grade fire retardant
- Gold plated contacts to ensure low contact resistance and tin plated terminal to prevent contamination during soldering

How to order

DSP – 42 – XX xx Z

Contact Type

42 = 4PDT

Device Type, Actuator, DIP Space & Packing

L01	= THT Type; Low Profile Actuator DIP space 8.50mm; Tube packing
LT01	= THT Type; Low Profile Actuator DIP space 8.50mm; Top sealed; Tube packing
E01	= THT Type; Extended Actuator DIP space 7.62mm; Tube packing
L02	= SMT Type; Low Profile Actuator; Tube packing
LT02	= SMT Type; Low Profile Actuator; Top sealed; Tube packing
LC02	= SMT Type; Low Profile Actuator; Reel packing
LD02	= SMT Type; Low Profile Actuator; Top sealed; Reel packing
E02	= SMT Type; Extended Actuator; Tube packing
EC02	= SMT Type; Extended Actuator; Reel packing