

1.27mm pitch Pin Header
 - SMT - low profile dual row

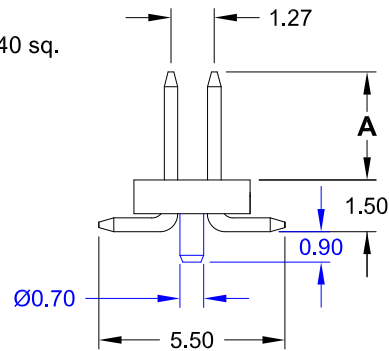
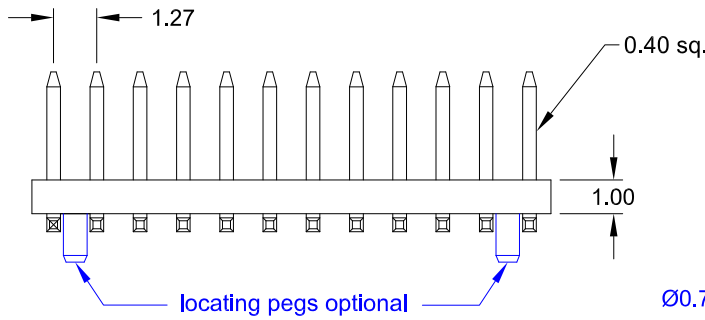
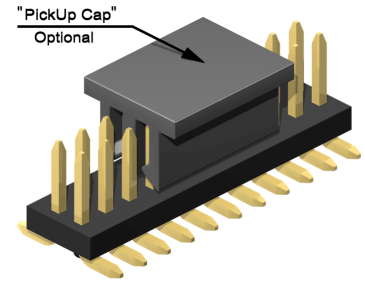
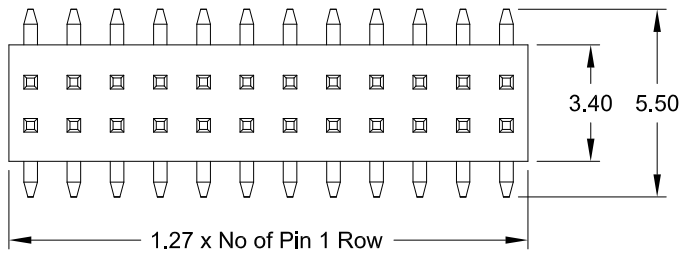

Application and Features

- **Standard: Tube packing, without "locating pegs" and without "PickUp Cap"**
- Assures reliable PC Board connections
- Low profile insulator
- Mates with 1.27mm pitch Female Headers

PCB Surface Mount Layout

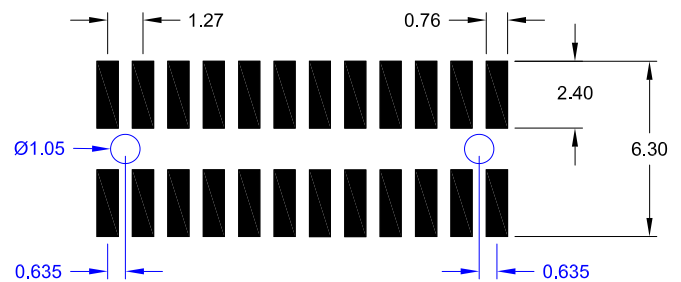

Specifications

| | |
|-----------------------|--------------|
| Current rating | 1 A |
| Insulation resistance | 1000 MΩ min. |
| Withstanding voltage | 500 V AC |

| | |
|------------------------|---------------------------------|
| Operating temperature | - 40°C to +105°C |
| Processing temperature | +250°C +0/-5°C for 5sec. |
| Contact material | (RoHS compliant) Copper Alloy |
| Insulator material | (RoHS compliant) PA6T UL 94 V-0 |

How to order

SS2 - xxx - H xx/x - 55/11 X

| Nbr of pins | Pin code | DIM "A" | Plating | Options |
|---|-----------------------------|----------|---------------------------|---|
| without locating pegs: 006 to 100 | 70/0 | 3.00 mm | 55 = Gold | without "locating pegs" |
| | 70/1 | 10.00 mm | | A = Tube packing; with „PickUp Cap“ |
| | 70/2 | 6.50 mm | | B = Reel packing; with „PickUp Cap“ |
| with locating pegs: 008 to 100 | 70/3 | 12.50 mm | other platings on request | with "locating pegs" (available only from 008 to 100 pins) |
| | 70/4 | 4.00 mm | | C = Tube packing; without „PickUp Cap“ |
| | other dimensions on request | | | D = Tube packing; with „PickUp Cap“ |
| | | | | E = Reel packing; with „PickUp Cap“ |