

S111 standard soldertail type

male

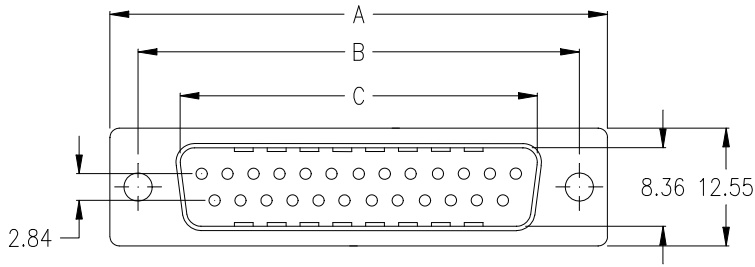

FERRITE SPECIFICATION

No of Contact	Measured Value(OHM)	Test Frequency	Ferrite thickness
009	20 min. 40 min.	25 MHz 100 MHz	1.20mm
015	15 min. 35 min.	25 MHz 100 MHz	
025	15 min. 40 min.	25 MHz 100 MHz	
037	20 min. 50 min.	25 MHz 100 MHz	

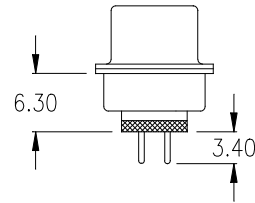
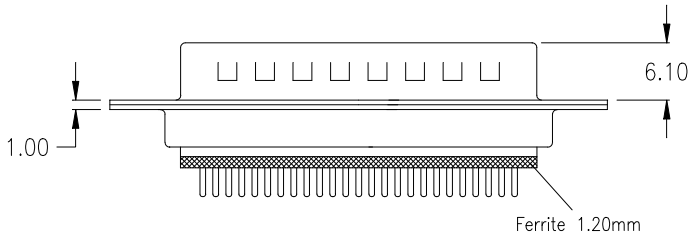

Ordering Code

SDM - xxx - S111 - 95 / F XXX

No. of contacts

Option

Plating: -95 = tin(leadfree)/gold

General Specification page 72

No. of contacts	Dimension		
	A	B	C
009	<u>30.81</u> 1.213	<u>24.99</u> .984	<u>16.92</u> .666
015	<u>39.14</u> 1.541	<u>33.32</u> 1.312	<u>25.25</u> .994
025	<u>53.04</u> 2.088	<u>47.04</u> 1.852	<u>38.96</u> 1.534
037	<u>69.32</u> 2.729	<u>63.50</u> 2.500	<u>55.42</u> 2.182

Options

mounting hole
ø 3.05

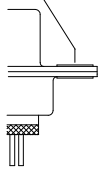

T0

thread rivet
4-40 UNC

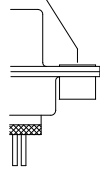

T

Jack Screw
4-40 UNC

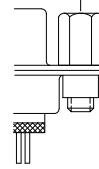

TJ

inside thread
4-40 UNC

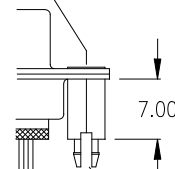

BR

Jack Screw
4-40 UNC

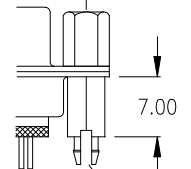

BRJ

PCB Layout „male“

9 pin

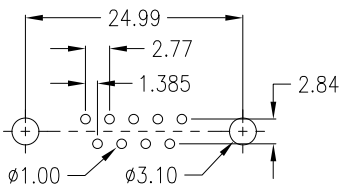

25 pin

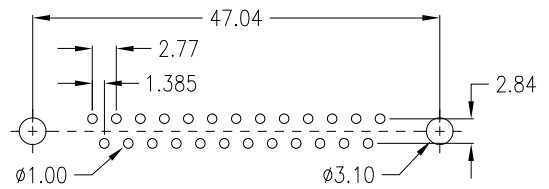

15 pin

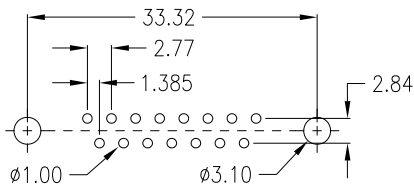

37 pin

